

Standard Oil Seals

# KC Type, KB Type

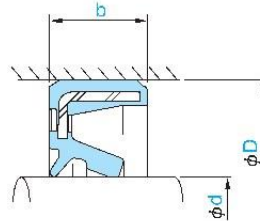

KC type

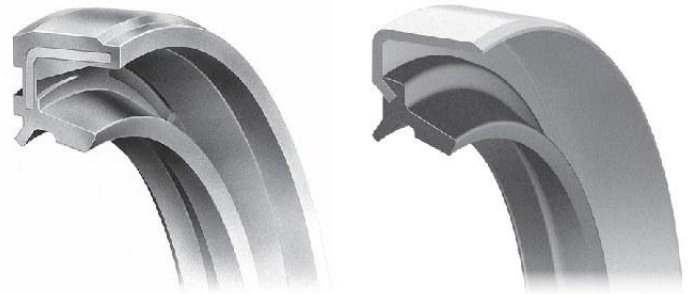
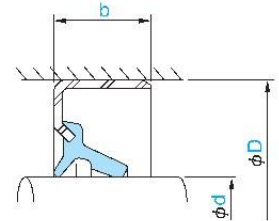

KB type

- The sectional view on the right shows the typical profile of the seal type.
- Please refer to page 25 for the respective advantages and disadvantages of Types B and C.
- Check the guide to allowable operating conditions on pages 10 and 11 for relevant information on the seal selected before use.

■ When ordering, please indicate the NOK part number and the relevant dimensions.

**Order Example** NOK Part Number: AG 0279 E0  
Type: KC, Shaft diameter: 10, Outside diameter: 25, Width: 7

14

KC, KB type

Dimensions			Part Number	
Shaft diameter d	Outside diameter D	Width b	Nitrile (NBR) A727	
			KC type	KB type
10	25	7	AG 0279 E0	—
15	30	7	AG 0598 E0	—
15	35	7	AG 0610 E0	—
18	28	6	AG 0807 E0	—
20	38	7	AG 1024 E0	—
22	38	8	—	AF 1133 E1
30	45	8	AG 1679 F1	—
32	52	8	—	AF 1902 F0
38	52	6	—	AF 2221 E0
38	55	8	—	AF 2230 E1
40	62	8	AG 2386 F0	—
45	62	6	—	AF 8088 E0
45	62	9	AG 2651 F1	—
48	65	9	—	AF 2780 E0
50	68	9	AG 2847 E0	—
64	82	7	—	AF 3370 E0
65	88	14	AG 3402 E0	—
90	115	13	AG 3932 E0	—